

COPYRIGHT 2021 GALLO HERBERT ARCHITECTS
WITHOUT THE PRIOR WRITTEN CONSENT OF GALLO HERBERT ARCHITECTS
IT IS A VIOLATION OF THE LAW FOR ANY PERSON, UNLESS ACTING UNDER THE DIRECTION OF A LICENSED ARCHITECT TO ALTER THESE PLANS AND SPECIFICATIONS. THIS DOCUMENT CONTAINS PROPERTY INFORMATION AND SHALL NOT BE USED OR REPRODUCED, OR ITS CONTENTS DISCLOSED, IN WHOLE OR IN PART, WITHOUT THE PRIOR WRITTEN CONSENT OF GALLO HERBERT ARCHITECTS. CONTRACTOR(S) SHALL VERIFY EXISTING CONDITIONS AND CORRELATE DIMENSIONS PRIOR TO PROVIDING THE WORK DETAILED IN THESE DRAWINGS, AND SHALL PROMPTLY NOTIFY THE DESIGNER OF ANY DISCREPANCIES.

NFPA LIFE SAFETY DATA	FLORIDA BUILDING CODE DATA
FLORIDA FIRE PREVENTION CODE, SEVENTH EDITION INCLUDING NFPA, 1 FIRE CODE AND NFPA 101, LIFE SAFTEY CODE, 2018 EDITION	FLORIDA BUILDING CODE 2020- SEVENTH EDITION
NEW AIRCRAFT HANGAR STORAGE OCCUPANCY CHAPTER 42 ORDINARY HAZARD BUILDING IS NOT FULLY SPRINKLERED	USE AND OCCUPANCY S-1 AIRCRAFT STORAGE HANGAR CHAPTER 3
NFPA 42.6 SPECIAL PROVISIONS FOR AIRCRAFT HANGARS	SPECIAL DETAILED REQUIREMENTS BASED ON USE & OCCUPANCY CHAPTER 4- 412- AIRCRAFT RELATED SPECIAL REQUIREMENTS
2 MEANS OF EGRESS REQUIRED FROM ALL AIRCRAFT HNAGAR AREAS.	[F] 412.4.6.1 HAZARDOUS OPERATIONS. ANY GROUP III AIRCRAFT HANGAR ACCORDING TO TABLE 412.4.6 THAT CONTAINS HAZARDOUS OPERATIONS INCLUDING, BUT NOT LIMITED TO, THE FOLLOWING SHALL BE PROVIDED WITH A GROUP I OR II FIRE SUPPRESSION SYSTEM IN ACCORDANCE WITH NFPA 409 AS APPLICABLE.
EXITS FROM AIRCRAFT STORAGE AREASSHALL BE AT INTERVALS NOT EXCEEDING 150 FT.	1. DOPING. 2. HOT WORK INCLUDING, BUT NOT LIMITED TO, WELDING, TORCH CUTTING AND TORCH SOLDERING 3. FUEL TRANSFER. 4. FUEL TANK REPAIR OR MAINTENANCE NOT INCLUDING DEFUELED TANKS IN ACCORDANCE WITH NFPA 409, INERTED TANKS OR TANKS THAT HAVE NEVER BEEN FUELED. 5. SPRAY FINISHING OPERATIONS. 6. TOTALRUEL CAPACITY OF ALL AIRCRAFT WITHIN THE UNSPRINKLERED SINGLE AREA IN EXCESS OF 1,600 GALLONS (6057 L). 7.TOTAL FUEL CAPACITY OF ALL AIRCRAFT WITHIN THE MAXIMUM SINGLE FIRE AREA IN EXCESS OF 7,500 GALLONS (28 390 L) FOR A HANGAR WITH AN AUTOMATIC SPRINKLER SYSTEM IN ACCORDANCE WITH SECTION 903.3.1.1.
HORIZAONTAL EXITS AT FIRE BARRIERS SHALL NOT EXCEED 100 FT. SPACING.	GENERAL BUILDING HEIGHTS AND AREAS CHAPTER 5- ALLOWABLE HEIGHT TYPE IIIB N.S. 55 FT.
"SMASH DOORS" NOT APPLICABLE	STORIES ABOVE GRADE PLANE S-1, N.S. = 3 MAX
MEZZANINES NOT APPLICABLE.	BUILDING AREA, S-1, N.S. = 17,500
DEAD ENDS SHALL NOT EXCEED 50 FT. FOR NON HIGH HAZARD AREAS.	AREA MOD. FOR BUILDING C NOT REQUIRED
MAXMUM COMMON PATH OF TRAVEL- ORDINARY HAZARD, UN-SPRINKLERED = 50 FT	TYPE CONSTRUCTION: IIIB
DEAD END 50 FT. MAX.	CH 6 FIRE RATED EXTERIOR WALLS S-1 OCC , X IS GREATER THAN
MAXIMUM TRAVEL DISTANCE TO EXITS ORDINARY HAZARD, UNSPRINKLERED=200 FT MAX	OR EQUAL TO 30 FT ALLOW ZERO HOUR RATED EXT WALLS.
UNPROTECTED VERTICAL OPENINGS NOT APPLICABLE	
INTERIOR WALL AND CEILING FINISHES-PER REQUIREMENTS	
DETECTION ALARM & COMMUNICATION NOT REQUIRED	
NFPA 409 STANDARD ON AIRCRAFT HANGERS	
GROUP III HANGAR TYPE III(200) CONSTRUCTION TYPE PER NFPA 220	
HANGAR DOORS LESS THAN 28 FT. HIGH	
MAXIMUM FIRE AREA LESS THAN 12,000 S.F.	
BUILDING UNSPRINKLERED AS ALLOWED AS ORDINARY HAZARD PER FBC 412.4.6.1	

EMERGENCY RADIO SIGNAL / BI-DIRECTIONAL AMPLIFICATION

ALL BUILDINGS SHALL BE TESTED FOR EMERGENY RADIO SIGNAL STREGTH AFTER THE SHELL IS CONSTRUCTED. VERIFY WITH MUNICIPALITY FIRE DEPARTMENT FOR TESTING REQUIREMENTS PRIOR TO TESTING. IF THE BUILDING IS FOUND TO REQUIRE A B.D.A. (BI-DIRECTIONAL AMPLIFICATION SYSTEM) OWNER WILL ENGAGE A SPECIALTY ENGINEER TO DESIGN A BOOSTER SYTEM IN FULL ACCORDANCE WITH NFPA 72 AND LOCAL AUTHORITIES HAVING JURISDICTION.

DETAILS OF CONSTRUCTION SUCH AS LOCATION OF HEAD END EQUIPMENT AND CABLE PATHWAYS VERTICALLY AND HORIZONTALLY SHALL BE SPECIFIED.

THE CONSTRUCTION DRAWINGS WILL INCLUDE PLANNING FOR POSSIBLE BDA EQUIPMENT LOCATION AND CONDUITS. BDA WILL BE IN A TWO HOUR FIRE RATED ROOM NOT LESS THAN 3'WIDE BY 5' LONG. VERTICAL CABLE CHASES IF NECESSARY WILL NEED TO PROVIDE 2 HOUR FIRE RATING. HORIZONTAL CABLE NEED NOT BE FIRE RATED. CABLE AND EQUIPMENT SHALL NOT BE LOCATED IN STAIRS

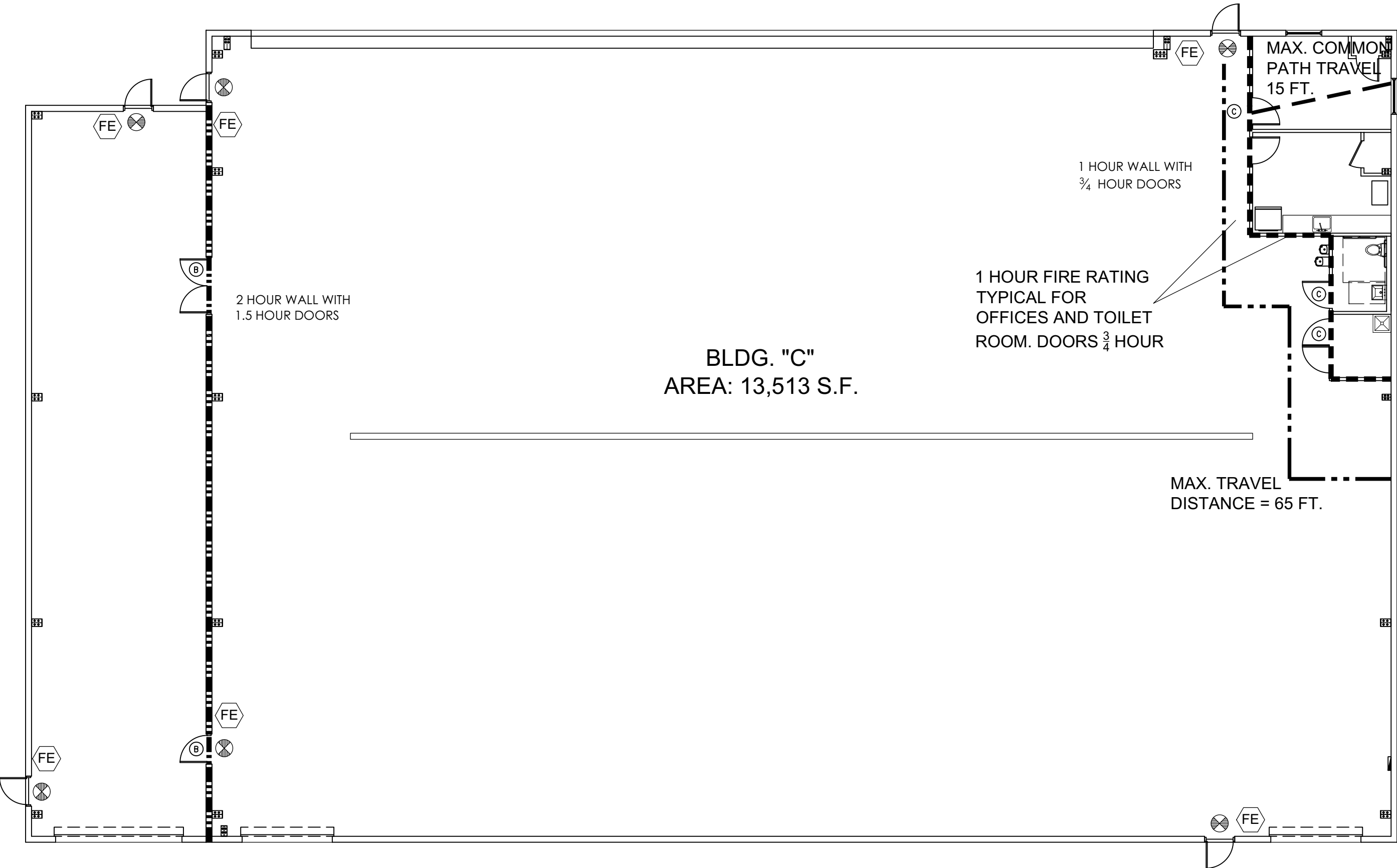

A4 BUILDING C LIFE SAFETY PLAN
3/32" = 1'-0"

GENERAL NOTES: UN-SPRINKLERED	LEGEND - - - - - TRAVEL DISTANCE PATH - - - - - COMMON PATH - - - - - DEAD-END CORRIDOR CLG. MTD. DIRECTIONAL EXIT SIGN WALL MTD. EXIT SIGN FIRE EXTINGUISHER - SEMI-RECESSED CABINET W/ 3A 4BC RATING FIRE EXTINGUISHER - WALL MOUNTED W/BRACKET W/ 3A 4BC RATING F.D. KEY BOX LOCATION (VERIFY W/ F.D. MANUF. TYPE KNOX OR SUPRA) EMERGENCY LIGHT	EGRESS DATA: FBC S-1 OCC OCCUPANCY LOAD MAX. TRAVEL DISTANCE TO EXIT (FT) MAX. DEAD END CORRIDOR MIN. CORRIDOR WIDTH MIN. CLEAR OPENING MAX. COMMON PATH (FT)	OCCUPANCY LOAD SUMMARY FBC CH 10 OCCUPANCY CLASSIFICATION: GROUP S-1 CAPACITY PER F.B.C 1004.5 AIRCRAFT HANGARS 1 PER 500 GROSS EACH HANGAR IS 5600 SF THEREFORE OCCUPANT LOAD IS 5600 / 500= 11.2 THEREFORE 13 PEOPLE EACH BAY.	INTERIOR FINISH CLASSIFICATION LIMITATIONS OCCUPANCY S-1 UN-SPRINKLERED WALL AND CEILING EXITS CORRIDORS OTHER SPACES FLOORS CLASS I OR II ARE PERMITTED CLASS II: CRITICAL RADIANT FLUX NOT LESS THAN 0.22 W/m ² BUT NOT LESS THAN 0.45
----------------------------------	--	---	---	---

LIFE SAFETY SYMBOLS

COMMON PATH OF TRAVEL

DEAD END

MAXIMUM TRAVEL DISTANCE

EXIT SIGNS, WITH OR WITHOUT DIRECTION ARROWS

EMERGENCY LIGHTS

FIRE EXTINGUISHERS DISTRIBUTED PER REQUIREMENTS ON ALL LEVELS.

FE FIRE EXTINGUISHER 2A-10B:C 5 LB.



1311 W NEWPORT CENTER DRIVE DEERFIELD BEACH FLORIDA 33442 PH. 954.794.0300 F.X. 954.794.0301

AA2226001731

WILLIAM J. GALLO FL AR0008440

Brian Herbert

Digitally signed by Brian Herbert

Date: 2022.06.30 14:34:52 -04'00'

BRIAN P. HERBERT FL AR0015474

POMPANO BEACH AIR PARK PARCEL Y

601 NE 10TH ST.
POMPANO BEACH
FL 33060

POMPANO BEACH

COMPANY NAME [REVISIONS]		
No.	Description	Date
B	D.R.C. SUBMITTAL	2022-06-28

PROJECT STATUS

D.R.C.

DATE

2021-03-24

PROJECT NUMBER

83-2020

SCALE

AS SHOWN

DRAWN BY

JET

CHECKED BY

JET

DRAWING TITLE

BLDG. "C" LIFE SAFETY PLAN

DRAWING NUMBER

C-A-102

DRC

PZ22-12000020

8/3/2022